



## Wyvern Gearbox fitted with Sagami 2840 Motor

Available Ratios: 18/1, 24/1, 36/1

Supplier: R.L.Moore Engineering

Motor Nominal Voltage 12V Stalled Current at 12V - 2.44A

For full motor details see Motor Data Sheets

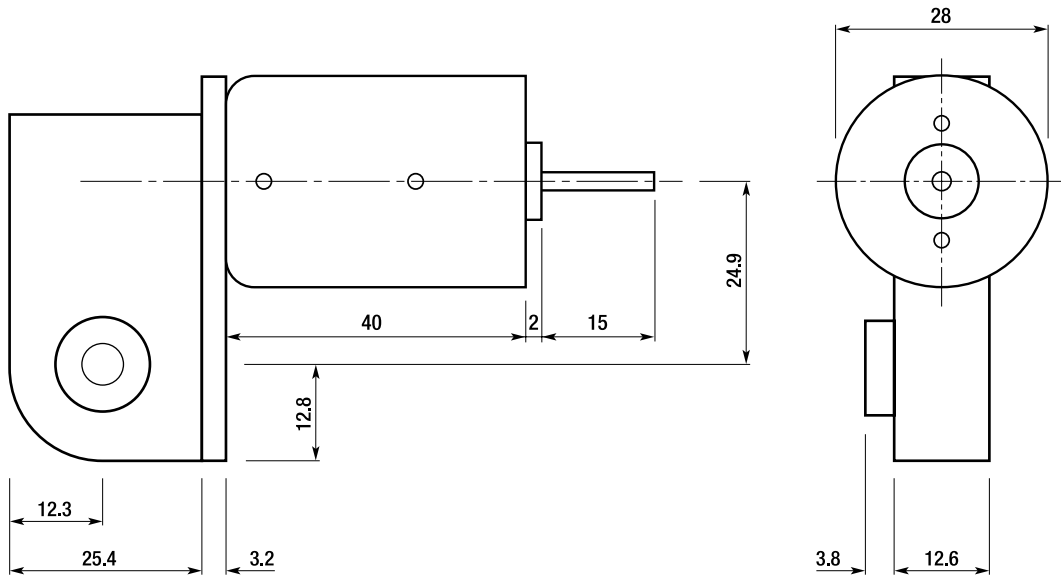

**Note:** The voltage is at the motor terminals. It is recommended that the supply voltage be at least 2V higher to allow for feeder and pick-up drop.

<b>Ratio</b>	<b>Performance</b>	<b>12V</b>	<b>16V</b>	<b>22V</b>
18/1	No Load Axle Speed (rpm)	361	481	662
	Stalled Torque (g.cm)	3228	4304	5918
	Speed Rating	271	361	496
	Torque Rating	807	1076	1479
24/1	No Load Axle Speed (rpm)	271	361	497
	Stalled Torque (g.cm)	3443	4591	6315
	Speed Rating	203	271	372
	Torque Rating	861	1148	1578
36/1	No Load Axle Speed (rpm)	180	240	331
	Stalled Torque (g.cm)	4528	6838	8302
	Speed Rating	135	180	248
	Torque Rating	1132	1510	2076